

Medical Supplies

Defibrillator

Defibrillator's
- Accessories and Consumables -

Defibrillator Paste, Disposable Pads, Battery

Disposable pads

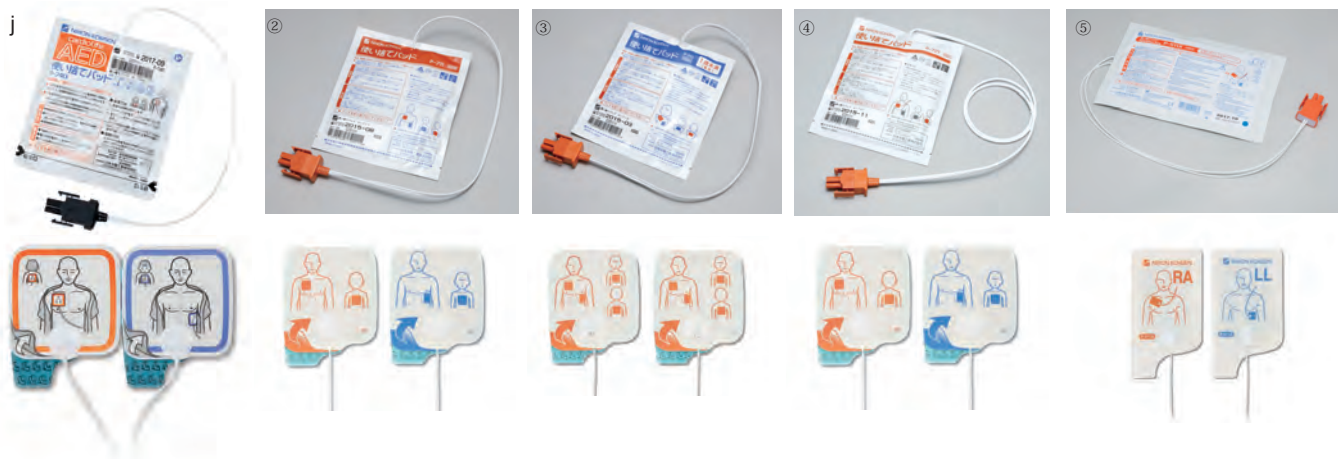

Code (Model)	Applicable	Length
· P-740K	Adult/pediatric	1.5m
· H329 (P-711)	Adult/pediatric	1.5m
· H330 (P-713)	Infant	1.5m
· H331 (P-721)	Adult/pediatric	2.5m
· H327A (P-511X)	Adult/pediatric	1.5m

Contact gel

Gelaid

Code (Model)	Qty
F015A (Z-101BA)	100 g × 2



Pad adapter

for TEC-5600/8300

Code (Model)
K342B (JC-865V)

for TEC-5500

Code (Model)
– (JC-765)

Test load unit

Code (Model)
Y206A (AX-250V)

Recording paper

for TEC-5500

Code (Model)	Qty	Type	Width × Length
A226 (FQS50-2-100)	10	Z-fold	50 mm × 20 m

for TEC-5600/8300

Code (Model)	Qty	Type	Width × Length
A128 (RQS50-3)	10	roll	50 mm × 30 m

Battery

for TEC-5500/5600



Code (Model)
X065 (NKB-301V)

for TEC-8300



Code (Model)
X077(SB-831V)

ECG connection cables

for TEC-5500



Code (Model)	Type	Lead
j K353A (BC-763V)	IEC	3
K352A (BC-763VA)	AHA	3
k K353B (BC-765V)	IEC	5
K352B (BC-765VA)	AHA	5

ECG connection cords

for TEC-5600/8300



for 3/6 electrodes

Code (Model)	Type	Cord
K922 (JC-906P)	IEC	3 m
K922A (JC-906PA)	AHA	3 m
K925 (JC-916P)	IEC	1.5 m

ECG patient cables

for TEC-8300



for 10 electrodes

Code (Model)	Type	Cord
K901 (BJ-900P)	IEC	3.8 m
K901A (BJ-900PA)	AHA	3.8 m

ECG patient cables

for TEC-8300



for 10 electrodes

Code (Model)	Type	Lead
j K354 (BJ-831V) + k K913A (BR-906V)	IEC	Limb + chest
K354A (BJ-831VA) + K913B (BR-906VA)	AHA	Limb + chest

Electrode leads



for 3 electrodes

Code (Model)	Type	Lead	Cord
K911 (BR-903P)	IEC	Clip	0.8 m
K911A (BR-903PA)	AHA	Clip	0.8 m
K910A (BR-913P)	IEC	Snap	0.8 m
K910B (BR-913PA)	AHA	Snap	0.8 m
K977 (BR-923P)	IEC	Clip	1.5 m



for 6 electrodes

Code (Model)	Type	Lead	Cord
K912 (BR-906P)	IEC	Clip	0.8 m
K912A (BR-906PA)	AHA	Clip	0.8 m
K915 (BR-916P)	IEC	Snap	0.8 m
K915A (BR-916PA)	AHA	Snap	0.8 m
K918 (BR-926P)	IEC	Clip	1.5 m

Vitrode *The result of over 30 years experience in disposable electrode manufacturing*

Disposable electrodes, Vitrode L

G207 (L-150X)



- 35 mm diameter for general adult use
- For general ECG and 12-lead ECG monitoring
- No gel remains when removed from skin
- Low impedance for clear waveforms
- Gentle on the skin
- Radiolucent

Disposable electrodes, Vitrode F

G210D (F-150M)



G210C (F-150S)



- Smaller size for neonate to child
- Entire attachment area has conductive and adhesive gel to reduce skin irritation
- Contain a bitter agent to help prevent accidental injection by children

Disposable electrodes, Vitrode V

G272C (V-060M6)

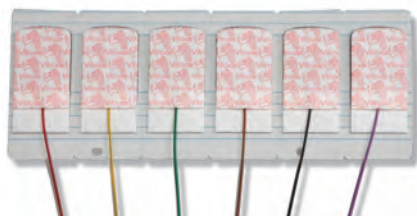

- Smaller size for neonate to child
- Lead wires are attached together to prevent tangling in incubators

Code (Model)	Qty	Usage	Size	Cord
G207 (L-150X)	30 pcs/pack × 5	Adult, radiolucent	35 mm dia	–
G210D (F-150M)	3 pcs/pack × 50	Adult, whole surface adhesion	25 × 45 mm	–
G210C (F-150S)	3 pcs/pack × 50	Neonate to child, whole surface adhesion	18 × 36 mm	–
G272C (V-060M6)	6 colors/pack × 10	Adult/child, prewired	25 × 45 mm	1.0 m

Disposable electrodes, Vitrode N

G300D (N-01IS3)



画像修正要

Long lasting Adhesion Gel

- Durable and adhesive gel hardly swells, preventing electrodes from peeling even under humid environment
- Smallest electrodes among Vitrode series
- Soft radiolucent lead wires are bundled to prevent the leads being tangled around the baby

Adhesibility <humidified environment>	★★★★
Adhesibility <non-humidified environment>	★★★★★
Skin-Friendliness	★
Strength to body movement	★★★★

画像修正要

G300A (N-03IS3)



画像修正要

Skin-Friendly with Gentle Adhesive

- Skin-friendly adhesive gel; gentle for less skin irritation
- Electrodes for the baby whose dermis is immature
- Soft radiolucent lead wires are bundled to prevent the leads being tangled around the baby

Adhesibility <humidified environment>	★
Adhesibility <non-humidified environment>	★★★★★
Skin-Friendliness	★★★★★
Strength to body movement	★★★

画像修正要

Disposable electrodes, Vitrode V

G271A (V-120S3)



画像修正要

Available from Neonate to Infant

- Bitter chemical compound is used on the electrodes to prevent accidental swallowing
- Electrodes are specifically designed for the more active baby
- Soft radiolucent lead wires are bundled to prevent the leads being tangled around the baby

Adhesibility <humidified environment>	★★★
Adhesibility <non-humidified environment>	★★★★★
Skin-Friendliness	★
Strength to body movement	★★★

画像修正要

Code (Model)	Qty	Usage	Size	Cord
G271A (V-120S3)	3 colors/pack × 40	Infant to neonate, prewired	20 × 20 mm	0.6 m
G300A (N-03IS3)	3 colors/pack × 10	NICU, prewired	14 × 25 mm	0.6 m
G300D (N-01IS3)	3 colors/pack × 10	Very low birth weight (less than 1500 g) Extremely low birth weight (less than 1000 g)	15 × 15 mm	0.6 m

cap-ONE
ORAL NASAL EXPIRATION

Nihon Kohden's unique sensing technology
both intubated and non-intubated mainstream CO₂ measurement



Weighs only 4 grams
IPX 7 protection against immersion in water

Accurate for intubated and non-intubated patients
Reliable even under high humidity conditions
Durable enough for use in harsh environments
Safe heaterless system prevents burn injuries

for TEC-5600/8300

CO2 mainstream, intubated (quantitative method)

Airway adapter (intubated)



Code (Model)	Dead Space	Weight	Usage	Connection	Qty
R805 (YG-211T)	4 mL	>7 kg	Adult	-	30
R806 (YG-213T)	0.5 mL	-	Infant/ neonate	Connecting with flow sensor or respiration circuit without inner connector	30
R807 (YG-214T)	1.8 mL	2.5 to 7 kg	Infant/ neonate	Connecting flow sensor with an inner connector	30

CO₂ mainstream, intubated and non-intubated (semi-quantitative method)

CO₂ sensor kit



Code (Model)
P907* (TG-920P) *TG-121T + JG-920P

CO₂ sensor



Code (Model)
P923 (TG-121T)

CO₂ adapter

Code (Model)
K984 (JG-920P)

Nasal adapters (non-intubated)

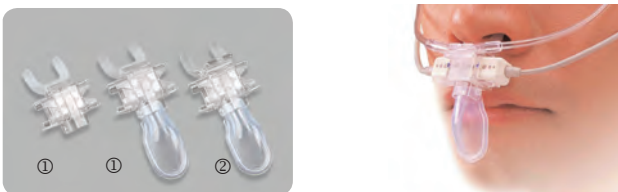

Code (Model)	Dead Space	Weight	Qty
① V921 (YG-120T)	1.2 mL	>10 kg	30
① V922 (YG-121T)	1.2 mL	>10 kg	30
② V923* (YG-122T)	1.2 mL	>10 kg	30

*with O₂ supply tube adapter

Airway adapter (intubated)



Code (Model)	Dead Space	Weight	Qty
R804 (YG-111T)	4 mL	>7 kg	30

for TEC-5500

CO₂ mainstream, intubated and non intubated (semi-quantitative method)

CO₂ sensor kit



Code (Model)

P908* (TG-921T3)

*TG-121T + JG-921T3

CO₂ sensor



Code (Model)

P923 (TG-121T)

CO₂ adapter

Code (Model)

K985 (JG-921T3)

Nasal adapters (non-intubated)

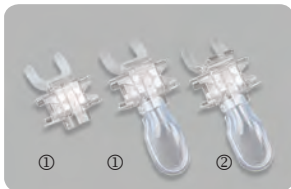

Code (Model)	Dead Space	Weight	Qty
① V921 (YG-120T)	1.2 mL	>10 kg	30
① V922 (YG-121T)	1.2 mL	>10 kg	30
② V923* (YG-122T)	1.2 mL	>10 kg	30

Airway adapter (intubated)



Code (Model)	Dead Space	Weight	Qty
R804 (YG-111T)	4 mL	>7 kg	30

*with O₂ supply tube adapter

CO₂ mainstream, intubated (semi-quantitative method)

for TEC-5600/8300

CO₂ sensor kit



Code (Model)

P903* (TG-900P) *TG-101T + JG-900P

CO₂ sensor



Code (Model)

P922A (TG-101T)

CO₂ adapter

Code (Model)

K981 (JG-900P)

Airway adapter



Code (Model)	Dead Space	Weight	Qty
R801 (YG-101T)	5 mL	>10 kg	50

for TEC-5500

CO₂ sensor kit



Code (Model)

P906* (TG-901T3)

CO₂ sensor



P922A (TG-101T)

CO₂ adapter

Code (Model)

K983 (JG-901T3)

Airway adapter



Code (Model)	Dead Space	Weight	Qty
R801 (YG-101T)	5 mL	>10 kg	50

BLUPRO SpO₂ probes

from the company that invented SpO₂

One-patient use SpO₂ probes

Self-adhesive type

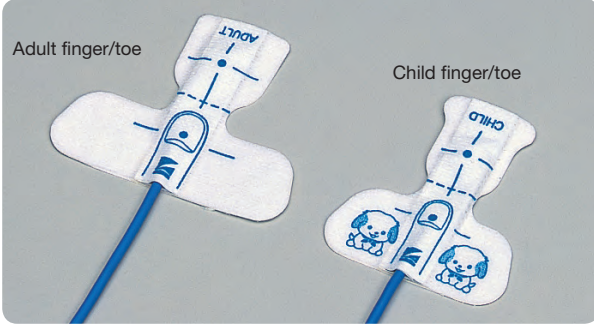

Adult finger/toe

Code (Model)	Cord	Qty	Code (Model)	Cord	Qty
P203A (TL-271T)	0.8 m	24	P204A (TL-271T)	0.8 m	5
P203E (TL-271T3)	1.6 m	24	P204E (TL-271T3)	1.6 m	5

Child finger/toe

Code (Model)	Cord	Qty	Code (Model)	Cord	Qty
P203B (TL-272T)	0.8 m	24	P204B (TL-272T)	0.8 m	5
P203F (TL-272T3)	1.6 m	24	P204F (TL-272T3)	1.6 m	5

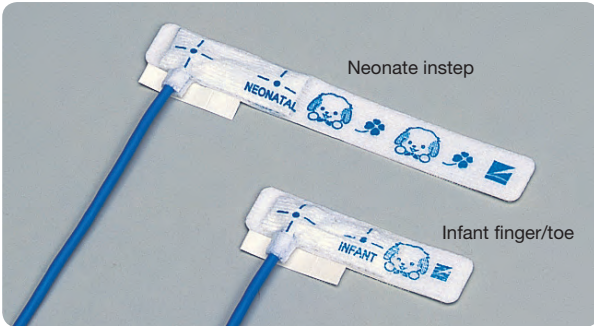

Neonate instep

Code (Model)	Cord	Qty	Code (Model)	Cord	Qty
P203C (TL-273T)	0.8 m	24	P204C (TL-273T)	0.8 m	5
P203G (TL-273T3)	1.6 m	24	P204G (TL-273T3)	1.6 m	5

Infant finger/toe

Code (Model)	Cord	Qty	Code (Model)	Cord	Qty
P203D (TL-274T)	0.8 m	24	P204D (TL-274T)	0.8 m	5
P203H (TL-274T3)	1.6 m	24	P204H (TL-274T3)	1.6 m	5

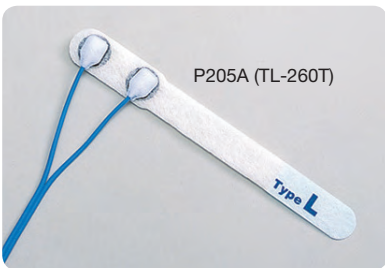

Non-adhesive, for sensitive skin

Code (Model)	Usage	Qty
P205A (TL-260T)	Neonate Adult (with ear clip)	1 sensor + 4 sponge tape L/set x 5



S size: P260E



L size: P260F



Ear clip, adult use with TL-260T

Attachment tape for TL-260T

Code (Model)	Size	Qty
P260E (-)	S: 1 kg or less at instep 3 kg to 10 kg at finger/toe	24
P260F (-)	L: 1 kg or more	24

Code (Model)
P256 (-)

Non-adhesive, for sensitive skin

Code (Model)	Attachment site	Qty
P206 (TL-535U)	Neonates and preterm infant	1 sensor + 3 sponge tape S/set x 5

Attachment tape for TL-535U

Code (Model)	Size	Qty
P264A (-)	S: 1 kg or less	24
P264B (-)	L: 2.5 kg or less	24

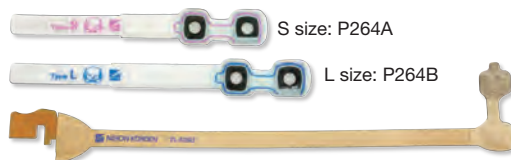

P206 (TL-535U)

BLUPRO *SpO₂ probes*

from the company that invented SpO₂

Reusable SpO₂ probes



Finger-clip type, 20 kg or more

Code (Model)	Cord
P225F (TL-201T)	1.6 m
P225H (TL-201T)	0.6 m



Multi-site, from neonate to adult, finger or instep

Code (Model)
P225G (TL-220T)



Finger-tip type, 20 kg or more

Code (Model)
P311C (TL-631T3)

Finger-tip type, 50 kg or more

Code (Model)
P310C (TL-630T3)

Fixing tapes



Code (Model)		Qty
① P259 (-)	COTTONY tape	20
② P263 (-)	BluPRO attachment tape	90
③ P267 (-)	Probe fastener	30

SpO₂ adapters

for TEC-5500



Code (Model)
Y095A (JL-550T2)











for TEC-5600/8300



Code (Model)
K931 (JL-900P)

BLUPRO *Reliable SpO₂ probes from the company that invented SpO₂*

Usage

		Low birth weight neonate	Neonate	Infant	Child			Adult	
[Weight]		1000g		3kg	10kg	20kg	30kg	40kg	50kg
One-patient use	TL-271T 							[Orange bar from 40kg to 50kg]	
	TL-272T 						[Orange bar from 30kg to 50kg]		
	TL-273T 			[Orange bar from 3kg to 10kg]					[Orange bar from 50kg to 60kg]
	TL-274T 				[Orange bar from 10kg to 20kg]				
	TL-260T 	Tape S instep	Tape L instep		Tape S finger/toe			[Orange bar from 40kg to 50kg with P256 ear clip]	
	TL-535U 	Tape S	Tape L						
Reusable	TL-201T 						[Orange bar from 30kg to 50kg]		
	TL-631T3 						[Orange bar from 30kg to 50kg]		
	TL-630T3 								[Orange bar from 50kg to 60kg]
	TL-220T 			[Orange bar from 3kg to 50kg]					

Nihon Kohden recommends combination use of one-patient use and reusable probes depending on patient condition.

Disposable NIBP cuffs



Code (Model)	Usage	Width	Range	Qty
⑭ S954A (YP-840P)	Infant	5 cm	8 - 13 cm	20
⑮ S954B (YP-840P)	Child	7 cm	13 - 18 cm	20
⑯ S954C (YP-840P)	Adult, Small	10 cm	18 - 23 cm	20
⑰ S954D (YP-840P)	Adult	13 cm	23 - 33 cm	20
⑱ S954E (YP-840P)	Adult, Large	16 cm	33 - 45 cm	20
⑲ S954F (YP-840P)	Thigh	19 cm	45 - 55 cm	20



Code (Model)	Usage	Width	Range	Qty
① S948A (YP-820P)	Neonate	2 cm	3 - 6 cm	20
② S948B (YP-821P)	Neonate	3 cm	4 - 8 cm	20
③ S948C (YP-822P)	Neonate	4 cm	6 - 11 cm	20
④ S948D (YP-823P)	Neonate	4.5 cm	7 - 13 cm	20
⑤ S948E (YP-824P)	Neonate	5 cm	8 - 15 cm	20
⑥ S945C (YP-810P)	Child	6 cm	8 - 14 cm	20
⑦ S945D (YP-811P)	Child	8 cm	13 - 20 cm	20
⑧ S946E (YP-812P)	Adult	10 cm	18 - 26 cm	20
⑨ S946F (YP-813P)	Adult	14 cm	26 - 35 cm	20
⑩ S946G (YP-814P)	Adult	15 cm	29 - 38 cm	20
⑪ S946H (YP-815P)	Adult	17 cm	32 - 42 cm	20
⑫ S946I (YP-816P)	Adult	18 cm	35 - 44 cm	20
⑬ S946J (YP-817P)	Thigh	20 cm	42 - 50 cm	20

YAWARA CUFF2



Yawara(kai)
means
“soft in touch”



Code (Model)	Usage	Width	Range
S951A (YP-710T)	Infant	5 cm	8 - 13 cm
S951B (YP-711T)	Child	7 cm	13 - 18 cm
S951C (YP-712T)	Adult, small	10 cm	18 - 23 cm
S951D (YP-713T)	Adult	13 cm	23 - 33 cm
S951E (YP-714T)	Adult, large	16 cm	33 - 45 cm
S951F (YP-715T)	Thigh	19 cm	45 - 55 cm

Reusable NIBP cuffs



Code (Model)	Usage	Width	Range
S943A (YP-960T)	Infant	5 cm	8 - 13 cm
S943B (YP-961T)	Child	7 cm	12 - 18 cm
S943C (YP-962T)	Child	10 cm	15 - 23 cm
S944B (YP-963T)	Adult	13 cm	21 - 30 cm
S944C (YP-964T)	Adult	15 cm	26 - 36 cm
S944D (YP-965T)	Thigh	19 cm	33 - 45 cm

NIBP adapters



Code (Model)	Usage	Cord
S902 (YN-901P)	Adult/child	3.5 m
S901 (YN-900P)	Adult/child	1.5 m

Extension cord for S901/S902

Code (Model)	Cord
S903 (YN-990P)	1.5 m

Defibrillator (for TEC-8300) Temperature, IBP AED Battery, Disposable Pads

Temperature

Temperature probes

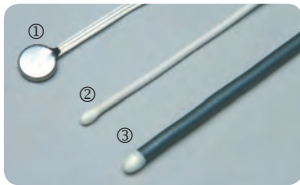

Code (Model)	Type
① P242D (409J)	Disk
② P241B (402J)	Catheter, child
③ P240B (401J)	Catheter, adult

Probe covers



Code (Model)	Qty
P249A (-)	10

*Use with P240B

Insulation pads



Code (Model)	Qty
P252 (-)	60

*Use with P242D

Temp connection cord



Code (Model)
K961 (JT-900P)

IBP

IBP connection cords



Code (Model)
K951 (JP-900P)

*Use with Becton Dickinson/ Algon Medical transducer



Code (Model)	Cord
L901 (JP-920P)	3.5 m
L902 (JP-921P)	1.5 m

*Use with Edwards Lifescience transducer



Code (Model)
K957 (JP-960P)

*Use with Biosensors transducer



Code (Model)
K952 (JP-910P)

*5P connector

AED Battery

for AED-2100/2150 series (Non-rechargeable)



Code (Model)	Stand-by life
- (SB-212VK)	2 years
- (SB-214VK)	4 years



for AED-2150 series (Rechargeable)



Code (Model)
X233(SB-220V)

for AED-3100 series (Non-rechargeable)



Code (Model)	Stand-by life
- (SB-310V)	4 years

Disposable pads

for AED-2100/2150 series



Code (Model)	Applicable
H324(P-530)	Adult/child

for AED-2100/2150 series/3100



Code (Model)	Applicable
- (P-740K)	Adult/child